

TRADE PRICE LIST MARCH 2012



HF



Halifax

cast iron soil and drain system

Hargreaves Foundry
'a cast iron guarantee'

Halifax Soil Products	Page
Pipes & Couplings	2
Bends	3
Branches	5
Other Fittings	7
Brackets & Clamps	9
Connectors & Tools	11

Halifax Drain Products	Page
Pipes & Couplings	12
Bends	13
Branches	14
Other Fittings	15
Brackets & Clamps	17
Connectors & Tools	18

Quality Assurance & Approvals

The Halifax Cast Iron Soil System for above ground use is approved under BBA Certificate No. 06/4401 for couplings, pipes & fittings up to ND200



Hargreaves Foundry have made every effort to ensure that the information contained in this publication is, to the best of our knowledge, accurate at the time of print. The company does not accept any responsibility for any errors within this literature. The company strives to continuously improve its products and therefore reserves the right to change, without prior notice, any of the data contained in this publication.

The Weights shown in this catalogue are accurate but subject to slight variance due to the manufacturing process.

All prices are in Pound Sterling and subject to VAT at the current rate. Any orders placed from this price list are subject to our standard Terms & Conditions. Details are available on request. Please refer to your current trading agreement for details of our discount structure.

Copyright © 2010 Hargreaves Foundry Drainage Ltd. All rights reserved. Any unauthorised copying or re-production will constitute an infringement of copyright.

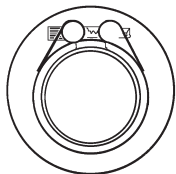
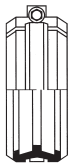
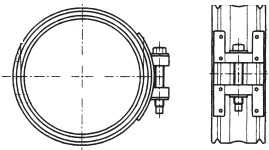
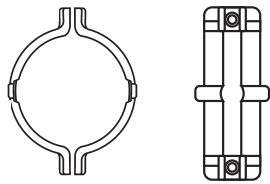
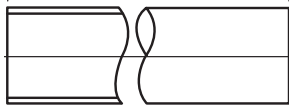

Double Spigot Pipes			
Product Code	Diameter (mm)	Nominal Weight (kg)	Price
HS2001	50	15.7	£52.27
HS3001	70	19.4	£59.88
HS4001	100	29.7	£71.09
HS6001	150	45.2	£139.94
HS8001	200	71.2	£234.24
HS10001	250	99.8	£329.49
HS12001	300	129.7	£409.68
Ductile Iron Couplings with Continuity			
Product Code	Diameter (mm)	Nominal Weight (kg)	Price
HS2012	50	0.7	£7.52
HS3012	70	0.8	£8.20
HS4012	100	1.1	£11.09
HS6012	150	2.0	£22.32
HS8012	200	3.5	£50.04
Stabilised Chrome Steel Max Couplings			
Product Code	Diameter (mm)	Nominal Weight (kg)	Price
HS2002	50	0.1	£6.95
HS3002	70	0.2	£7.70
HS4002	100	0.2	£9.59
HS6002	150	0.3	£19.26
Stabilised Chrome Steel Connect Couplings			
Product Code	Diameter (mm)	Nominal Weight (kg)	Price
HS8002	200	0.5	£45.46
HS10002	250	0.9	£71.48
HS12002	300	1.0	£82.57
Stainless Steel High Performance Couplings			
Product Code	Diameter (mm)	Bolt Size	Price
HS2069	50	M8	£147.66
HS3069	70	M10	£154.27
HS4069	100	M10	£156.25
HS6069	150	M12	£271.69
HS8069	200	M16	£401.31

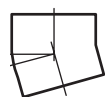
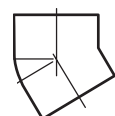
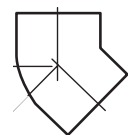
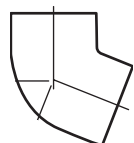
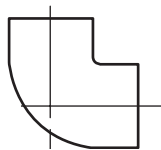

88° Short Radius Bends			
Product Code	Diameter (mm)	Nominal Weight (kg)	Price
HS2003	50	0.8	£13.05
HS3003	70	1.3	£14.77
HS4003	100	2.5	£17.44
HS6003	150	5.1	£31.67
HS8003	200	9.0	£90.30
HS10003	250	17.3	£180.65
HS12003	300	27.3	£250.37
69° Short Radius Bends			
Product Code	Diameter (mm)	Nominal Weight (kg)	Price
HS2004	50	0.8	£13.05
HS3004	70	1.1	£14.77
HS4004	100	2.0	£17.44
HS6004	150	4.6	£31.67
45° Short Radius Bends			
Product Code	Diameter (mm)	Nominal Weight (kg)	Price
HS2005	50	0.6	£13.05
HS3005	70	0.9	£14.77
HS4005	100	1.6	£17.44
HS6005	150	3.6	£31.67
HS8005	200	6.4	£90.30
HS10005	250	11.0	£180.65
HS12005	300	18.5	£250.37
30° Short Radius Bends			
Product Code	Diameter (mm)	Nominal Weight (kg)	Price
HS2006	50	0.5	£13.05
HS3006	70	0.8	£14.77
HS4006	100	1.4	£17.44
HS6006	150	3.2	£31.67
15° Short Radius Bends			
Product Code	Diameter (mm)	Nominal Weight (kg)	Price
HS2007	50	0.4	£13.05
HS3007	70	0.6	£14.77
HS4007	100	1.2	£17.44
HS6007	150	2.5	£31.67

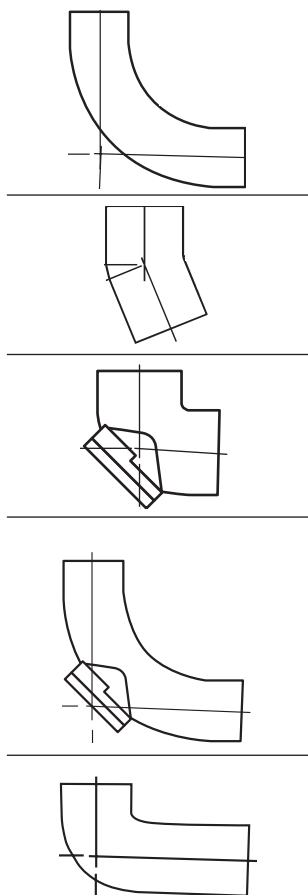

88° Long Radius Bends			
Product Code	Diameter (mm)	Nominal Weight (kg)	Price
HS4008	100	5.3	£42.22
HS6008	150	10.7	£117.63
22° Long Radius Bend			
Product Code	Diameter (mm)	Nominal Weight (kg)	Price
HS4009	100	2.2	£32.55
88° Short Radius Bends with Door			
Product Code	Diameter (mm)	Nominal Weight (kg)	Price
HS3010	70	2.5	£28.40
HS4010	100	3.8	£41.64
88° Long Radius Bends with Door			
Product Code	Diameter (mm)	Nominal Weight (kg)	Price
HS4011	100	7.3	£53.80
HS6011	150	12.7	£135.39
88° Long Tail Bend			
Product Code	Diameter (mm)	Nominal Weight (kg)	Price
HS4013	100	4.0	£30.77

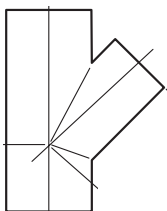
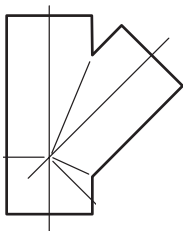
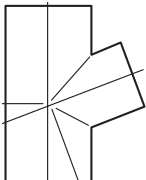
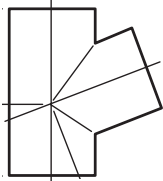
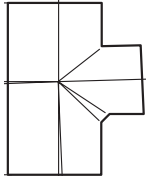
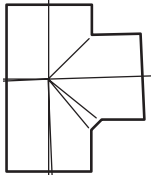

88° Single Equal Branches			
Product Code	Diameter (mm)	Nominal Weight (kg)	Price
HS2020	50 x 50	1.1	£21.15
HS3021	70 x 70	1.8	£22.45
HS4022	100 x 100	3.4	£28.34
HS6021	150 x 150	7.4	£68.13
HS8020	200 x 200	14.0	£181.61
HS10020	250 x 250	23.5	£403.74
HS12020	300 x 300	35.0	£524.90
88° Single Unequal Branches			
Product Code	Diameter (mm)	Nominal Weight (kg)	Price
HS3020	70 x 50	1.5	£22.45
HS4020	100 x 50	2.2	£30.15
HS4021	100 x 70	2.5	£30.15
HS6020	150 x 100	5.1	£66.58
69° Single Equal Branches			
Product Code	Diameter (mm)	Nominal Weight (kg)	Price
HS2023	50 x 50	1.1	£21.15
HS3024	70 x 70	1.8	£22.45
HS4025	100 x 100	3.4	£28.34
69° Single Unequal Branches			
Product Code	Diameter (mm)	Nominal Weight (kg)	Price
HS3023	70 x 50	1.4	£22.45
HS4023	100 x 50	2.1	£30.15
HS4024	100 x 70	2.6	£30.15
HS6023	150 x 100	4.9	£66.58
45° Single Equal Branches			
Product Code	Diameter (mm)	Nominal Weight (kg)	Price
HS2026	50 x 50	1.3	£21.15
HS3027	70 x 70	2.2	£22.45
HS4028	100 x 100	4.3	£28.34
HS6027	150 x 150	10.2	£68.13
HS8028	200 x 200	16.8	£181.61
HS10028	250 x 250	32.0	£403.74
HS12028	300 x 300	54.0	£524.90
45° Single Unequal Branches			
Product Code	Diameter (mm)	Nominal Weight (kg)	Price
HS3026	70 x 50	1.8	£22.45
HS4026	100 x 50	2.4	£30.15
HS4027	100 x 70	3.1	£30.15
HS6028	150 x 70	4.9	£66.58
HS6026	150 x 100	5.8	£66.58
HS8026	200 x 100	9.1	£169.12
HS8027	200 x 150	13.2	£169.12

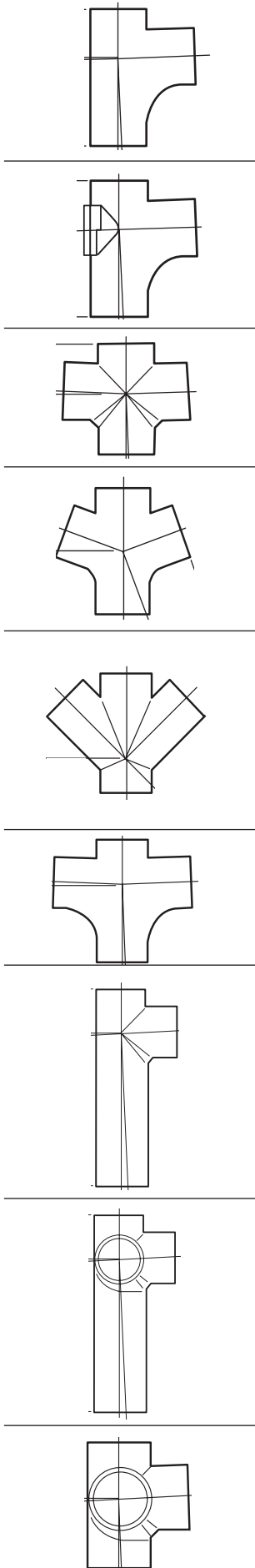

88° Single Radius Curve Branches			
Product Code	Diameter (mm)	Nominal Weight (kg)	Price
HS4030	100 x 100	4.1	£32.17
HS6030	150 x 100	6.5	£76.29
HS6031	150 x 150	11.7	£97.79
88° Single Radius Curve Branches with Door			
Product Code	Diameter (mm)	Nominal Weight (kg)	Price
HS4032	100 x 100	5.4	£53.52
HS6032	150 x 100	9.5	£115.40
HS6033	150 x 150	14.2	£118.56
88° Double Branch			
Product Code	Diameter (mm)	Nominal Weight (kg)	Price
HS4034	100 x 100	3.8	£40.95
69° Double Branch			
Product Code	Diameter (mm)	Nominal Weight (kg)	Price
HS4035	100 x 100	4.1	£40.95
45° Double Branches			
Product Code	Diameter (mm)	Nominal Weight (kg)	Price
HS4036	100 x 100	5.7	£40.95
HS6036	150 x 100	6.5	£124.36
HS6037	150 x 150	11.7	£137.97
HS8036	200 x 200	21.0	£218.29
88° Double Radius Curve Branches			
Product Code	Diameter (mm)	Nominal Weight (kg)	Price
HS4038	100 x 100	5.3	£40.21
HS6038	150 x 100	8.2	£128.61
88° Single Long Tail Branch			
Product Code	Diameter (mm)	Nominal Weight (kg)	Price
HS4040	100 x 100	5.2	£98.89
88° Single Long Tail Corner Branch			
Product Code	Diameter (mm)	Nominal Weight (kg)	Price
HS4041	100 x 100	7.0	£116.04
88° Single Short Tail Corner Branch			
Product Code	Diameter (mm)	Nominal Weight (kg)	Price
HS4042	100 x 100	3.5	£73.80

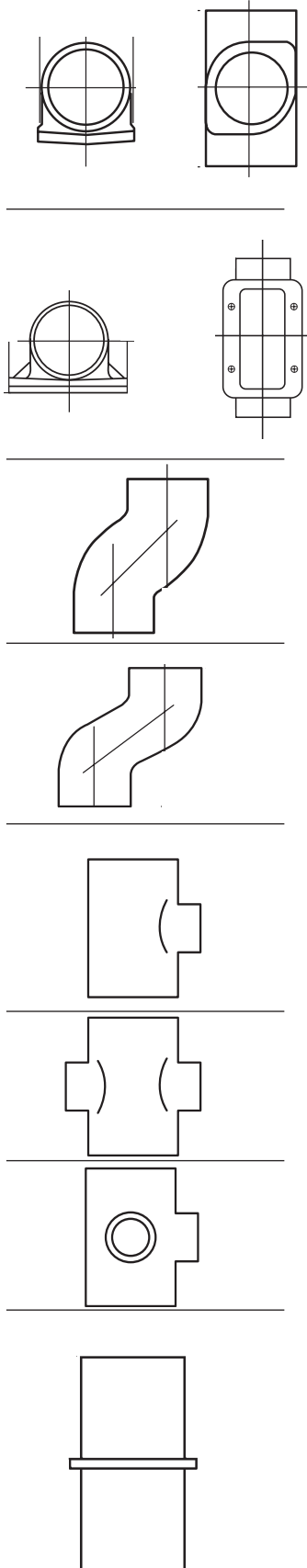

Access Pipes with Round Door

Product Code	Diameter (mm)	Nominal Weight (kg)	Price
HS2043	50	1.7	£34.82
HS3043	70	2.5	£37.04
HS4043	100	4.3	£39.01
HS6043	150	7.9	£72.92

Access Pipes with Rectangular Door

Product Code	Diameter (mm)	Nominal Weight (kg)	Price
HS4049	100	7.2	£50.24
HS6049	150	13.5	£115.26
HS8049	200	22.0	£243.11
HS10049	250	37.5	£390.15
HS12049	300	50.0	£492.02

Offsets 75mm Projection

Product Code	Diameter (mm)	Nominal Weight (kg)	Price
HS4044	100	2.6	£27.79

Offsets 130mm Projection

Product Code	Diameter (mm)	Nominal Weight (kg)	Price
HS2045	50	1.4	£22.30
HS3045	70	2.3	£33.98
HS4045	100	3.8	£44.42

Boss Pipes Single 2" BSPT

Product Code	Diameter (mm)	Nominal Weight (kg)	Price
HS3053	70	1.6	£29.95
HS4053	100	2.1	£36.57
HS6053	150	3.6	£58.53

Boss Pipe 2 x 2" BSPT Opposed

Product Code	Diameter (mm)	Nominal Weight (kg)	Price
HS4054	100	2.2	£43.00

Boss Pipe 2 x 2" BSPT at 90°

Product Code	Diameter (mm)	Nominal Weight (kg)	Price
HS4055	100	2.2	£43.00

Stack Support Pipes

Product Code	Diameter (mm)	Nominal Weight (kg)	Price
HS3056	70	1.8	£28.63
HS4056	100	2.8	£31.63
HS6056	150	4.3	£50.09
HS8056	200	7.2	£73.73
HS10056	250	12.5	£227.71
HS12056	300	16.9	£274.82

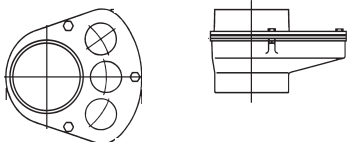
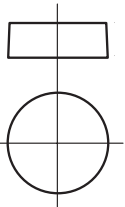
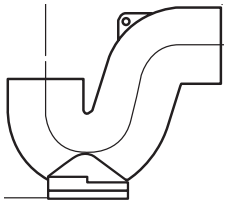
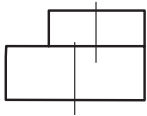
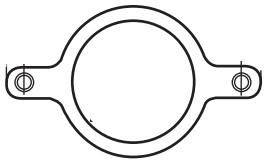

Stack Support Brackets with Gasket			
Product Code	Diameter (mm)	Nominal Weight (kg)	Price
HS3057	70	1.0	£17.65
HS4057	100	1.4	£21.83
HS6057	150	1.8	£33.40
HS8057	200	2.2	£66.76
HS10057	250	6.0	£118.12
HS12057	300	12.0	£156.11

Pipe Tapers			
Product Code	Diameter (mm)	Nominal Weight (kg)	Price
HS3046	70 x 50	0.6	£19.20
HS4046	100 x 50	0.9	£23.83
HS4047	100 x 70	1.1	£23.83
HS6046	150 x 50	2.5	£45.32
HS6047	150 x 70	2.7	£45.32
HS6048	150 x 100	2.4	£45.32
HS8046	200 x 100	4.0	£74.08
HS8047	200 x 150	4.0	£74.08
HS10046	250 x 100	5.5	£154.80
HS10047	250 x 150	6.3	£154.80
HS10048	250 x 200	6.5	£154.80
HS12046	300 x 150	9.9	£211.18
HS12047	300 x 200	10.1	£211.18
HS12048	300 x 250	12.2	£211.18

P Traps with Bottom Door			
Product Code	Diameter (mm)	Nominal Weight (kg)	Price
HS2050	50	2.3	£49.27
HS3050	70	3.6	£49.27
HS4050	100	6.8	£53.17
HS6050	150	15.8	£95.48

Blank Ends			
Product Code	Diameter (mm)	Nominal Weight (kg)	Price
HS2051	50	0.2	£5.27
HS3051	70	0.4	£5.57
HS4051	100	0.8	£6.52
HS6051	150	1.6	£9.41
HS8051	200	2.9	£40.66
HS10051	250	5.7	£84.10
HS12051	300	10.1	£121.06

Blank Ends Drilled & Tapped 2" BSPT			
Product Code	Diameter (mm)	Nominal Weight (kg)	Price
HS4052	100	0.7	£14.60
HS6052	150	1.5	£17.85

Manifold Connector			
Product Code	Diameter (mm)	Nominal Weight (kg)	Price
HS4058	100	3.5	£77.32

Manifold Connector fitted with 3 rubber plugs suitable for pushfit connection to 32mm/40mm diameter plastic/copper waste.

Halifax Coated Steel Adjustable Brackets

Product Code	Diameter (mm)	Nominal Weight (kg)	Price
HS2067	50	0.3	£7.69
HS3067	70	0.3	£7.69
HS4067	100	0.6	£8.80
HS6067	150	0.8	£16.37
HS8067	200	1.8	£60.66

Zinc Plated Rubber Lined Bismat Brackets

Product Code	Diameter (mm)	G	Price
HS2061	50	M8/M10	£3.10
HS3061	70	M8/M10	£4.21
HS4061	100	M8/M10	£6.00
HS6061	150	M10	£11.70
HS8061	200	M10	£17.44

Zinc Plated Heavy Duty Bossed Brackets

Product Code	Diameter (mm)	G	Price
HS2063	50	M8/M10	£5.58
HS3063	70	M10/M12	£5.99
HS4063	100	M10/M12	£7.96
HS6063	150	M10/M12	£13.94
HS8063	200	M10/M12	£18.07
HS10063	250	M16	£25.68
HS12063	300	M16	£39.18

Zinc Plated Rubber Lined Heavy Duty Bossed Brackets

Product Code	Diameter (mm)	G	Price
HS2064	50	M8/M10	£5.99
HS3064	70	M10/M12	£7.32
HS4064	100	M10/M12	£10.62
HS6064	150	M10/M12	£19.50
HS8064	200	M10/M12	£22.61
HS10064	250	M16	£35.22
HS12064	300	M16	£51.56

Galvanised Pipe Clamps

Product Code	Diameter (mm)	G	Price
HS2062	50	M10	£5.38
HS3062	70	M10	£6.14
HS4062	100	M10	£6.42
HS6062	150	M10	£8.78
HS8062	200	M10	£11.89
HS10062	250	12.5mm	£31.44
HS12062	300	12.5mm	£33.89

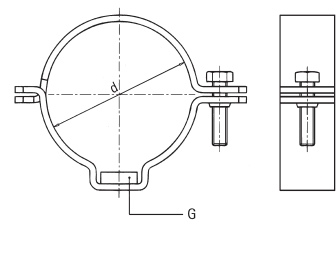
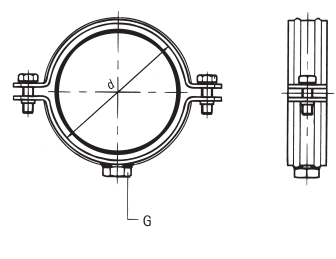
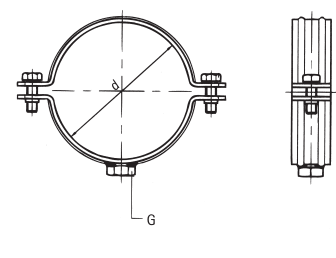
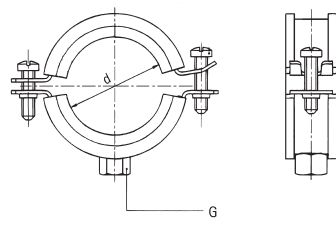
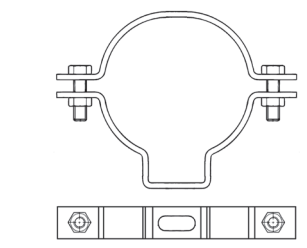

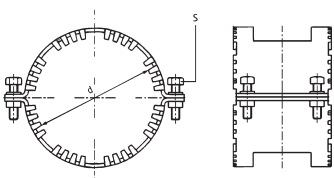
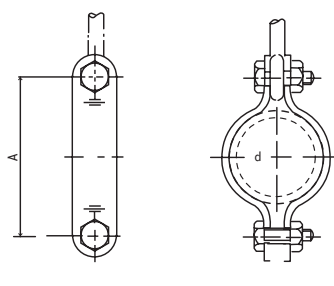

Zinc Plated Split Band Clips

Product Code	Diameter (mm)	A (mm)	Price
HS2065	50	114	£3.38
HS3065	70	116	£3.53
HS4065	100	176	£3.61
HS6065	150	226	£7.61
HS8065	200	297	£10.24
HS10065	250	371	£18.92
HS12065	300	420	£23.81

Zinc Plated Halifax Grips

Product Code	Diameter (mm)	S	Price
HS2060	50	M8 x 30	£42.10
HS3060	70	M8 x 30	£43.05
HS4060	100	M8 x 30	£46.17
HS6060	150	M10 x 30	£69.10
HS8060	200	M10 x 30	£90.71

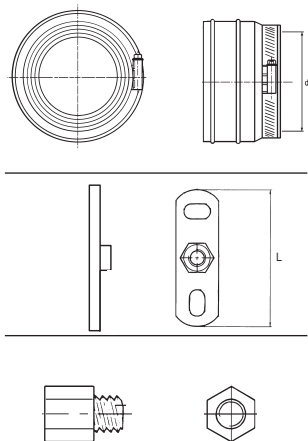

Rubber Halifax Fix Connectors			
Product Code	Diameter (mm)	To Fit (mm)	Price
HS2068	50	40 - 56	£8.25
HS3068	70	56 - 75	£11.36
HS4068	100	104 - 110	£12.39
Zinc Plated Wall Plate			
Product Code	L (mm)	Bolt Size	Price
HSD6702	80	M10	£2.14
Zinc Plated Thread Adapter			
Product Code	Male Thread	Female Thread	Price
HSD10/12	M10	M12	£2.17
Ratchet Spanner			
Product Code	Drive (mm)	Price	
HSD001	13.0	£67.30	
Socket (for Access Door Bolts)			
Product Code	Diameter (mm)	Price	
HSD002	13.0	£9.97	
Allen Socket Adapters (for Couplings)			
Product Code	Diameter (mm)	Price	
HSD003	6.0	£13.70	
HSD004	8.0	£14.10	
Hex Allen Key (for Couplings)			
Product Code	Diameter (mm)	Price	
HSD005	3.0	£9.17	

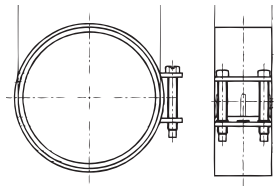
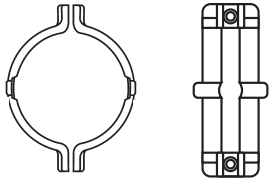
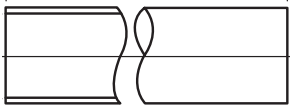

Double Spigot Pipes			
Product Code	Diameter (mm)	Nominal Weight (kg)	Price
HD4001	100	29.7	£88.88
HD6001	150	45.2	£174.93
HD8001	200	71.2	£292.80
HD10001	250	99.8	£428.34
HD12001	300	129.7	£532.59
Ductile Iron Couplings			
Product Code	Diameter (mm)	Nominal Weight (kg)	Price
HD4012	100	1.1	£14.98
HD6012	150	2.0	£30.15
HD8012	200	3.5	£67.58
Stainless Steel CV Couplings			
Product Code	Diameter (mm)	Nominal Weight (kg)	Price
HD10002	250	0.9	£95.61
HD12002	300	1.0	£102.68

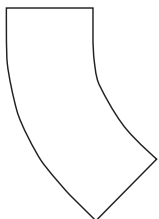
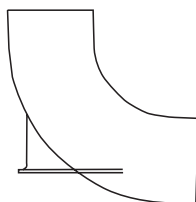
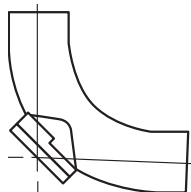
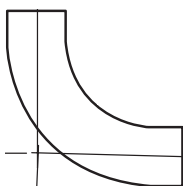
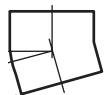
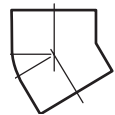
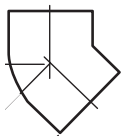

45° Short Radius Bends			
Product Code	Diameter (mm)	Nominal Weight (kg)	Price
HD4005	100	1.6	£20.92
HD6005	150	3.6	£36.42
HD8005	200	6.4	£108.39
HD10005	250	11.0	£207.71
HD12005	300	18.5	£287.91
30° Short Radius Bends			
Product Code	Diameter (mm)	Nominal Weight (kg)	Price
HD4006	100	1.4	£20.92
HD6006	150	3.2	£36.42
15° Short Radius Bends			
Product Code	Diameter (mm)	Nominal Weight (kg)	Price
HD4007	100	1.2	£20.92
HD6007	150	2.5	£36.42
88° Long Radius Bends			
Product Code	Diameter (mm)	Nominal Weight (kg)	Price
HD4008	100	5.3	£48.56
HD6008	150	10.7	£135.29
22° Long Radius Bend			
Product Code	Diameter (mm)	Nominal Weight (kg)	Price
HD4009	100	2.2	£35.84
88° Long Radius Bends with Door			
Product Code	Diameter (mm)	Nominal Weight (kg)	Price
HD4011	100	7.3	£61.86
HD6011	150	12.7	£148.93
88° Long Radius Bends with Heel Rest			
Product Code	Diameter (mm)	Nominal Weight (kg)	Price
HD4014	100	5.5	£59.17
HD6014	150	11.4	£145.45
45° Medium Radius Bends			
Product Code	Diameter (mm)	Nominal Weight (kg)	Price
HD4015	100	3.5	£34.27
HD6015	150	6.2	£75.11

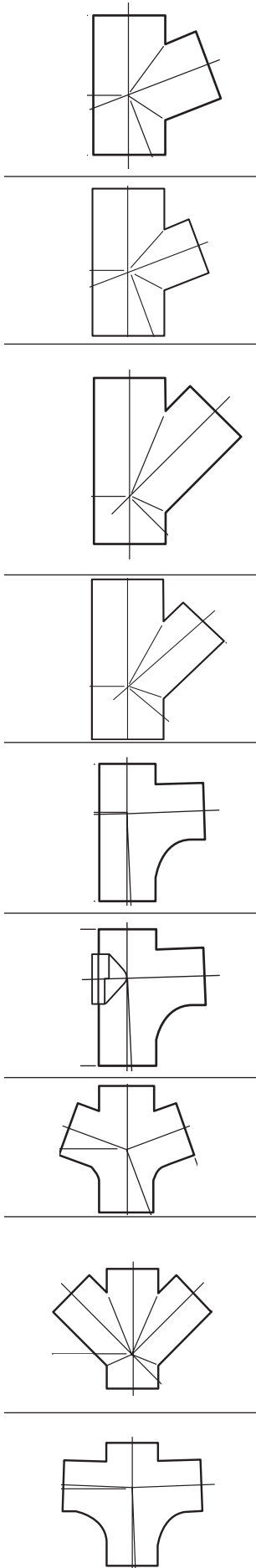

69° Single Equal Branch			
Product Code	Diameter (mm)	Nominal Weight (kg)	Price
HD4025	100 x 100	3.4	£32.60
69° Single Unequal Branch			
Product Code	Diameter (mm)	Nominal Weight (kg)	Price
HD6023	150 x 100	4.9	£76.55
45° Single Equal Branches			
Product Code	Diameter (mm)	Nominal Weight (kg)	Price
HD4028	100 x 100	4.3	£32.60
HD6027	150 x 150	10.2	£78.34
HD8028	200 x 200	16.8	£208.85
HD10028	250 x 250	32.0	£464.30
HD12028	300 x 300	54.0	£656.15
45° Single Unequal Branches			
Product Code	Diameter (mm)	Nominal Weight (kg)	Price
HD6026	150 x 100	5.8	£76.55
HD8026	200 x 100	9.1	£194.50
HD8027	200 x 150	13.2	£194.50
88° Single Radius Curve Branches			
Product Code	Diameter (mm)	Nominal Weight (kg)	Price
HD4030	100 x 100	4.1	£36.98
HD6030	150 x 100	6.5	£99.17
HD6031	150 x 150	11.7	£122.24
88° Single Radius Curve Branches with Door			
Product Code	Diameter (mm)	Nominal Weight (kg)	Price
HD4032	100 x 100	5.4	£64.24
HD6032	150 x 100	9.5	£126.95
HD6033	150 x 150	14.2	£130.39
69° Double Branch			
Product Code	Diameter (mm)	Nominal Weight (kg)	Price
HD4035	100 x 100	4.1	£47.10
45° Double Branches			
Product Code	Diameter (mm)	Nominal Weight (kg)	Price
HD4036	100 x 100	5.7	£47.10
HD6036	150 x 100	6.5	£136.81
HD6037	150 x 150	11.7	£172.46
HD8036	200 x 200	21.0	£240.11
88° Double Radius Curve Branches			
Product Code	Diameter (mm)	Nominal Weight (kg)	Price
HD4038	100 x 100	5.3	£46.24
HD6038	150 x 100	8.2	£155.97

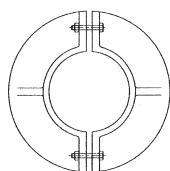
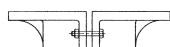
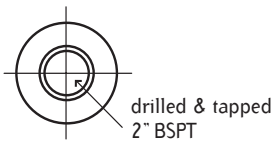
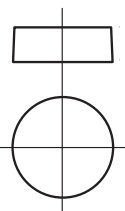
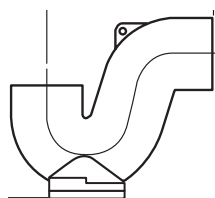
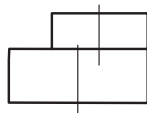
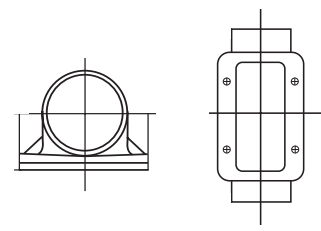
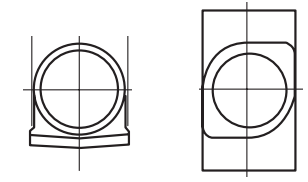

Access Pipes with Round Door			
Product Code	Diameter (mm)	Nominal Weight (kg)	Price
HD4043	100	4.3	£44.84
HD6043	150	7.9	£80.20
Access Pipes with Rectangular Door			
Product Code	Diameter (mm)	Nominal Weight (kg)	Price
HD4049	100	7.2	£62.83
HD6049	150	13.5	£138.30
HD8049	200	22.0	£283.50
HD10049	250	37.5	£448.67
HD12049	300	50.0	£538.70
Pipe Tapers			
Product Code	Diameter (mm)	Nominal Weight (kg)	Price
HD6048	150 x 100	2.4	£49.84
HD8046	200 x 100	4.0	£85.18
HD8047	200 x 150	4.0	£85.18
HD10046	250 x 100	5.5	£178.02
HD10047	250 x 150	6.3	£178.02
HD10048	250 x 200	6.5	£178.02
HD12046	300 x 150	9.9	£242.82
HD12047	300 x 200	10.1	£242.82
HD12048	300 x 250	12.2	£242.82
P Traps with Bottom Door			
Product Code	Diameter (mm)	Nominal Weight (kg)	Price
HD4050	100	6.8	£61.16
HD6050	150	15.8	£109.81
Blank Ends			
Product Code	Diameter (mm)	Nominal Weight (kg)	Price
HD4051	100	0.8	£7.52
HD6051	150	1.6	£10.82
HD8051	200	2.9	£46.77
HD10051	250	5.7	£96.75
HD12051	300	10.1	£133.18
Blank Ends Drilled & Tapped 2" BSPT			
Product Code	Diameter (mm)	Nominal Weight (kg)	Price
HD4052	100	0.7	£16.05
HD6052	150	1.5	£19.61
Puddle Flanges			
Product Code	Diameter (mm)	Nominal Weight (kg)	Price
HD4078	100	4.0	£52.51
HD6078	150	6.0	£62.54
HD8078	200	7.0	£81.77
HD10078	250	11.0	£85.19
HD12078	300	13.0	£102.78

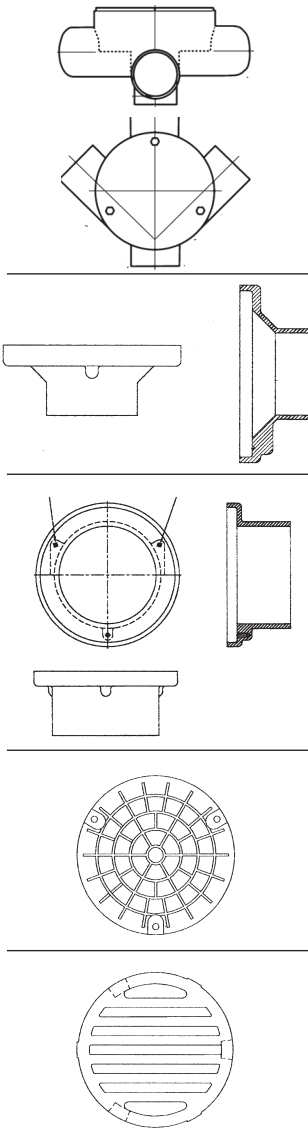

Inspection Chambers			
Product Code	Diameter (mm)	Nominal Weight (kg)	Price
HD4480	100 x 100	15.9	£211.32
HD6680	150 x 150	19.4	£328.17
Bellmouth Gully Inlet			
Product Code	Diameter (mm)	Nominal Weight (kg)	Price
HD4070	100	2.4	£37.88
Gully Inlet			
Product Code	Diameter (mm)	Nominal Weight (kg)	Price
HD6071	150	2.9	£52.58
Solid Cover with Rubber Seal & Screws			
Product Code	Diameter (mm)	Nominal Weight (kg)	Price
HD8076	200	2.2	£16.27
Plain Grating			
Product Code	Diameter (mm)	Nominal Weight (kg)	Price
HD8077	200	1.8	£9.14

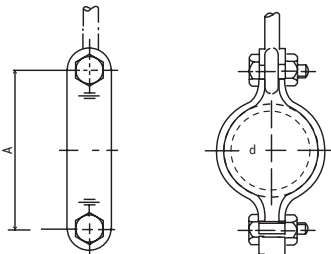
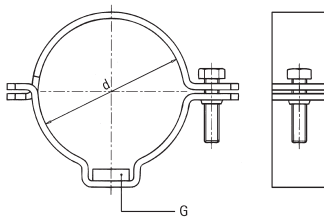
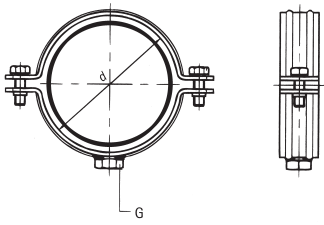
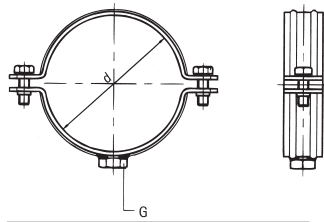
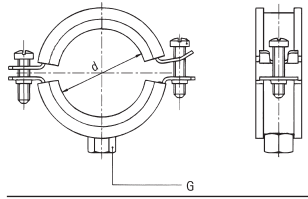
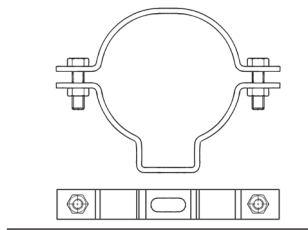

Halifax Coated Steel Adjustable Brackets			
Product Code	Diameter (mm)	Nominal Weight (kg)	Price
HD4067	100	0.6	£9.67
HD6067	150	0.8	£18.00
HD8067	200	1.8	£66.73
Zinc Plated Rubber Lined Bismat Brackets			
Product Code	Diameter (mm)	G	Price
HS4061	100	M8/M10	£6.00
HS6061	150	M10	£11.70
HS8061	200	M10	£17.44
Zinc Plated Heavy Duty Bossed Brackets			
Product Code	Diameter (mm)	G	Price
HS4063	100	M10/M12	£7.96
HS6063	150	M10/M12	£13.94
HS8063	200	M10/M12	£18.07
HS10063	250	M16	£25.68
HS12063	300	M16	£39.18
Zinc Plated Rubber Lined Heavy Duty Bossed Brackets			
Product Code	Diameter (mm)	G	Price
HS4064	100	M10/M12	£10.62
HS6064	150	M10/M12	£19.50
HS8064	200	M10/M12	£22.61
HS10064	250	M16	£35.22
HS12064	300	M16	£51.56
Galvanised Pipe Clamps			
Product Code	Diameter (mm)	G	Price
HS4062	100	M10	£6.42
HS6062	150	M10	£8.78
HS8062	200	M10	£11.89
HS10062	250	12.5mm	£31.44
HS12062	300	12.5mm	£33.89
Zinc Plated Split Band Clips			
Product Code	Diameter (mm)	A (mm)	Price
HS4065	100	176	£3.61
HS6065	150	226	£7.61
HS8065	200	297	£10.24
HS10065	250	371	£18.92
HS12065	300	420	£23.81

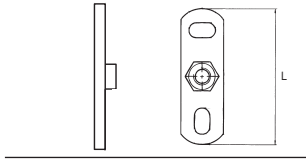

Zinc Plated Wall Plate			
Product Code	L (mm)	Bolt Size	Price
HSD6702	80	M10	£2.14
Zinc Plated Thread Adapter			
Product Code	Male Thread	Female Thread	Price
HSD10/12	M10	M12	£2.17
Ratchet Spanner			
Product Code	Drive (mm)	Price	
HSD001	13.0	£67.30	
Socket (for Access Door Bolts)			
Product Code	Diameter (mm)	Price	
HSD002	13.0	£9.97	
Allen Socket Adapters (for Couplings)			
Product Code	Diameter (mm)	Price	
HSD003	6.0	£13.70	
HSD004	8.0	£14.10	



Hargreaves

RAINWATER • SOIL • DRAINAGE

Hargreaves Drainage Water Lane South Parade Halifax West Yorkshire HX3 9HG

Telephone: 01422 330607 Fax: 01422 320349 E-Mail: info@hargreavesfoundry.co.uk www.hargreavesfoundry.co.uk